

Name: Ron Rossetti

Date: 02-05-07 Event: _____

City: _____ State: CA

Track: Revelation, ARC, Thunder Alley, HRP

Track Indoor Tight Smooth Hard Packed Blue Groove Wet Low Bite High Bite
 Conditions Outdoor Open Rough Loose/Loamy Dry Dusty Med Bite Other _____

Front Suspension

Toe: 1 deg toe-out
 Ride Height: 33mm
 Camber: -1 deg
 Caster: Stock
 Sway Bar: 2.3mm
 Piston/Oil: # 54, 40 wt. oil
 Spring: Grey
 Limiter/Droop: 95mm
 Overall Shock Length: _____
 Steering Ackerman: Long
 Bump Steer: Down
 Camber Link: 1
 Shock Location: 1 Inside
 Front Diff Fluid: 7,000 cs
 Receiver Battery Type: LiPo
 Center Diff Fluid: 10,000 cs

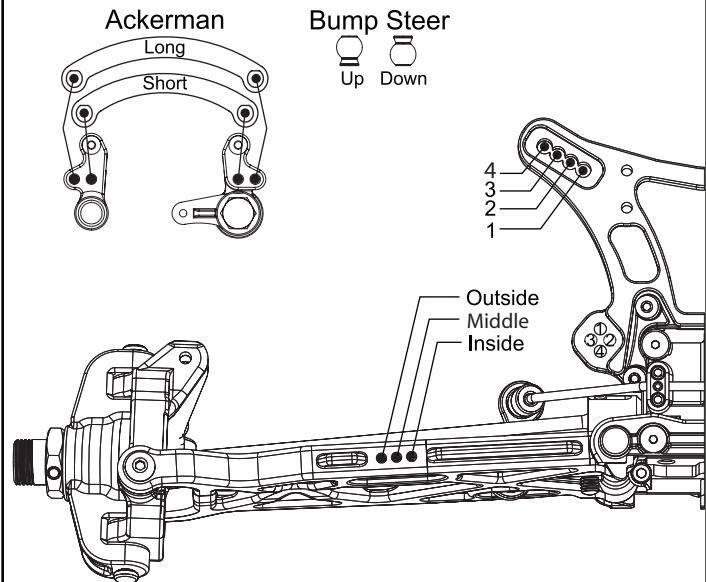

Notes: _____

Rear Suspension

Toe: 2 deg toe-in
 Anti-Squat: 3 deg
 Ride Height: 46mm
 Camber: -2 deg
 Rear Hub Spacing: forward
 Sway Bar: 2.7mm
 Piston/Oil: #56, 32.5wt oil
 Spring: purple
 Limiter/Droop: 110mm
 Overall Shock Length: _____
 Camber Link: 1,C
 Shock Location: 1/ Inside
 Rear Diff Fluid: 5,000 cs

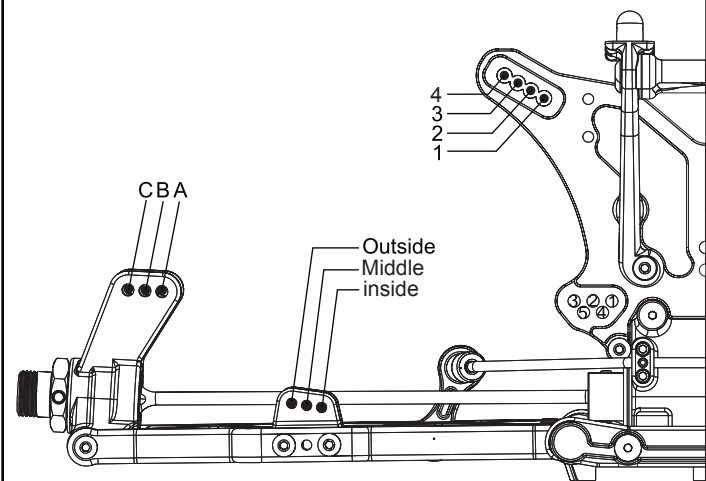

Notes: _____

Engine

Engine: Rex .28 Fuel: Losi Race 30%
 Glow Plug: _____ Head Clearance: _____
 Pipe/Header: _____ Gearing: 13-48

Clutch

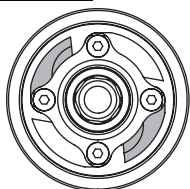

Clutch Shoes and Springs Info

2 Blue Alum w/ Gold Springs
2 Silver Alum w/Silver Springs

Tires

Type	Compound	Insert
Front: _____	_____	_____
Rear: _____	_____	_____
Notes: _____	_____	_____