

Name: Mike Truhe

Date: 2.24.07

Event: Dirt Nitro Challenge

City: Wittman State: AZ

Track: Nitro Pit

Track Indoor Tight Smooth Hard Packed Blue Groove Wet Low Bite High Bite
 Conditions Outdoor Open Rough Loose/Loamy Dry Dusty Med Bite Other _____

Front Suspension

Toe: 2 degrees Toe Out
 Ride Height: 36mm
 Camber: -1 degree
 Caster: Stock
 Sway Bar: 2.3mm
 Piston/Oil: 54/40wt Team Losi
 Spring: Black 5.0 lbs
 Limiter/Droop: 95mm
 Overall Shock Length: _____
 Steering Ackerman: Short
 Bump Steer: Down
 Camber Link: #2
 Shock Location: #3/Middle
 Front Diff Fluid: 7000wt Team Losi
 Receiver Battery Type: Dynamite 1400

 Center Diff Fluid: 10000wt Team Losi

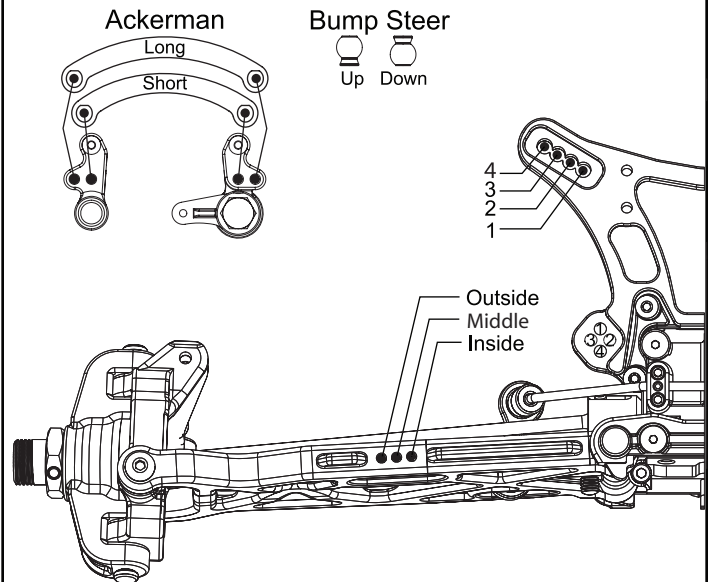

Notes: _____

Rear Suspension

Toe: 2 Degrees
 Anti-Squat: 3 Degrees
 Ride Height: 38mm
 Camber: -2 Degrees
 Rear Hub Spacing: Forward
 Sway Bar: 2.3mm
 Piston/Oil: 56/30wt Team Losi
 Spring: Grey 4.0 lb
 Limiter/Droop: 110mm
 Overall Shock Length: _____
 Camber Link: 4/A
 Shock Location: 3/Middle
 Rear Diff Fluid: 5000wt Team Losi

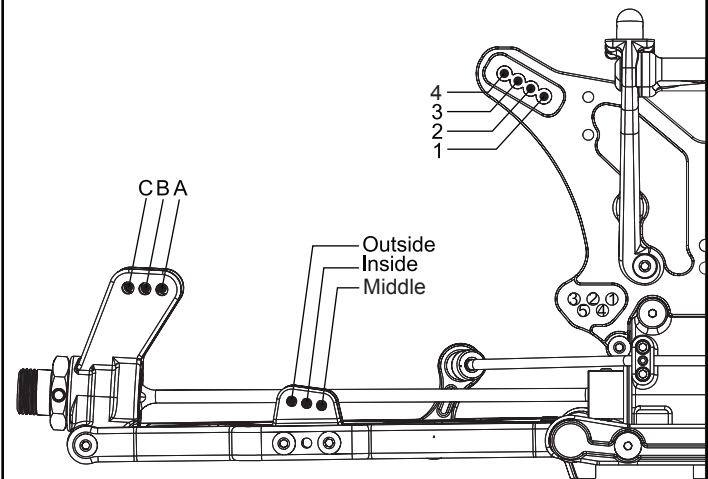

Notes: _____

Engine

Engine: Novarossi .28 Fuel: Nitrotane 30%
 Glow Plug: Novarossi 6 Head Clearance: n/a
 Pipe/Header: Novarossi 9901 Gearing: 13/48

Clutch

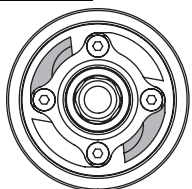

Clutch Shoes and Springs Info

2 Aluminum-Silver Springs
2 Plastic- Gold Springs

Tires

Type	Compound	Insert
Front: <u>TL XTT</u>	<u>Blue</u>	<u>Stock</u>
Rear: <u>TL XTT</u>	<u>Blue</u>	<u>Stock</u>

Notes: _____
